

# Sherford: June 2017 HCA update



# Introductions....

- ✓ **Paul Boileau**  
Development Manager for Taylor Wimpey, Linden & Bovis
- ✓ **Richard Darlow**  
Production Project Director for Sherford



# Infrastructure....

- ✓ > £35m investment since August 2015
- ✓ Deep Lane: Phase 1 & 2
- ✓ Stanborough Cross
- ✓ Haye Road
- ✓ Main Street
- ✓ New foul drainage pumping station
- ✓ New electricity primary substation
- ✓ SuDS: swales and tanks
- ✓ Community Park & mitigation landscaping
- ✓ ManCo & Community Trust established

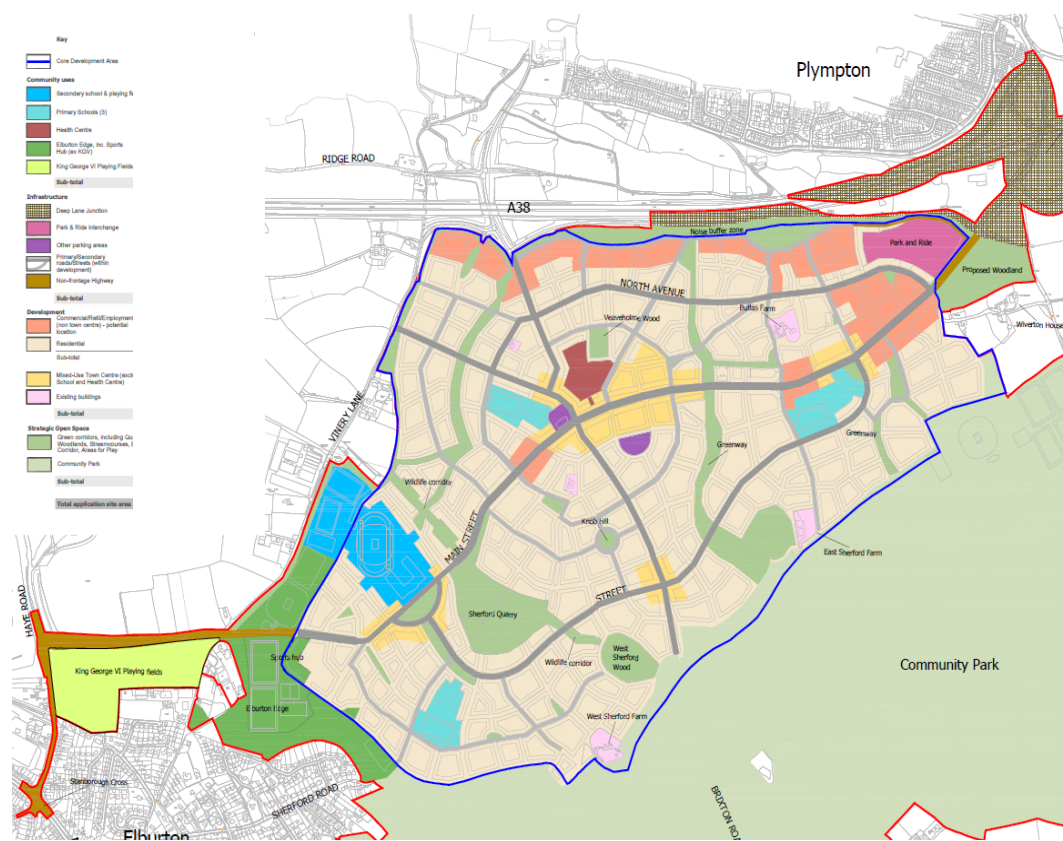

# New housing....

- ✓ Reserved Matters consent for circa 600 homes
- ✓ Commenced construction on 240 homes
- ✓ Two sales centres open. TW opening July
- ✓ 31 at reservation
- ✓ 3 at exchange
- ✓ 4 occupations
- ✓ First occupation in May 2017





# Phase 1.1....





- ✓ Insufficient space for water and lack of climate change allowance
- ✓ Certain conflicts between masterplan and topography
- ✓ Difficult land use arrangements
- ✓ Prescriptive product. Limited scope to evolve proposals
- ✓ Rate of sales is presently too low



# Next steps....

- ✓ Implement Strategic Review
- ✓ Temporary / permanent school
- ✓ Leisure centre
- ✓ Local centre
- ✓ Main Street to Deep Lane
- ✓ Western pitches
- ✓ Phase 1.2





Any questions?

